









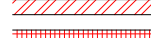

| REFERENCE | BEAM |
|-----------|--|
| G2 | CATNIC C690/100 - 150mm END BEARINGS |
| G3 | CATNIC C690/100 - 150mm END BEARINGS |
| G4 | CATNIC C690/100 - 150mm END BEARINGS |
| G5 | SEE ENGINEERS DESIGN |
| G7 | CATNIC C16XA PER LEAF - 150MM END BEARINGS - OR SIMILAR TO SUIT WALL |
| G8 | SEE ENGINEERS DESIGN |
| G9 | SEE ENGINEERS DESIGN |

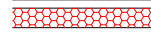
-  MAINS WIRED FIRE DETECTION AND SIREN POINT - INTERLINKED WITH BATTERY BACKUP
-  FIRE DOOR FDSO RATED WITH INTUMESCENT STRIPS

-  FACING BRICKWORK WITH DETAILING
-  MEDIUM DENSITY BLOCKWORK
-  DENSE CONCRETE BLOCK MINIMUM 1850kg/Mcu
-  LIGHTWEIGHT BLOCKWORK - CELCON SOLAR OR SIMILAR
-  STANDARD STUD PARTITION
-  STUD PARTITION SUBJECT TO PART E
-  UPGRADED WALL FOR THERMAL RESISTANCE
-  UPGRADED WALL FOR SOUND RESISTANCE

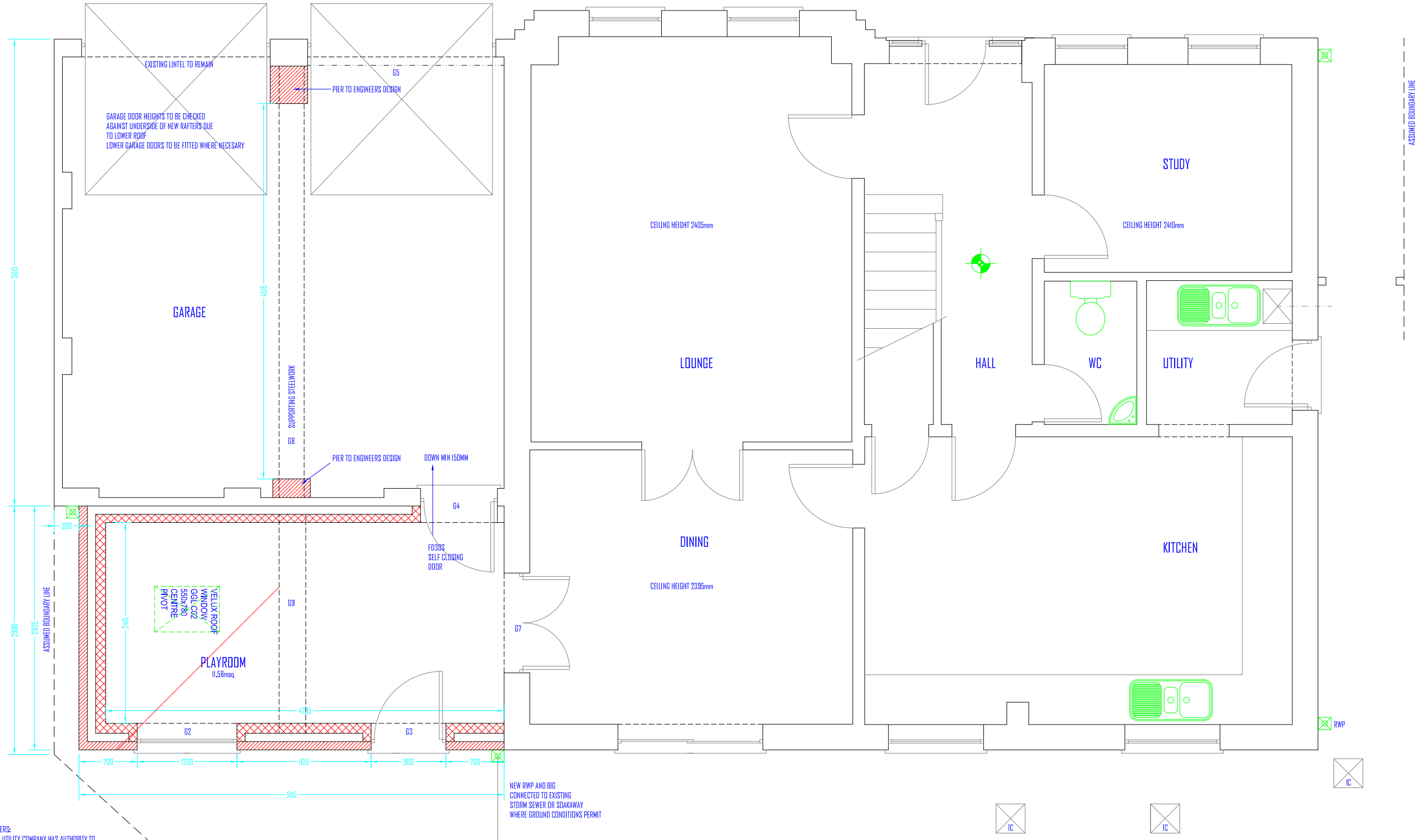

PUBLIC SEWERS:
YOUR LOCAL UTILITY COMPANY HAS AUTHORITY TO REJECT BUILDING CONTROL APPLICATIONS FOR PROPOSALS AFFECTING THEIR PLANT / SERVICES ENSURE FULL APPROVAL IS GAINED PRIOR TO COMMENCEMENT OF SITE WORKS
ALL DRAIN RUNS ARE ASSUMED AND SHOULD BE VERIFIED BY AN APPROVED SEWER SURVEY TEAM

NEW RWP AND BIG CONNECTED TO EXISTING STORM SEWER OR SOAKAWAY WHERE GROUND CONDITIONS PERMIT

PROPOSED GROUND FLOOR PLAN 1:50 @ A3

COPYRIGHT AZTECH ARCHITECTURE LTD
RESPONSIBILITY IS NOT ACCEPTED FOR ERRORS MADE BY OTHERS IN SCALING FROM THIS DRAWING
ALL DIMENSIONS, LEVELS AND ANGLES TO BE CHECKED ON SITE BY CONTRACTOR
ALL BOUNDARIES ARE ASSUMED AND WE ACCEPT NO LIABILITY FOR BOUNDARY INACCURACY
YOU ARE REMONDED OF YOUR RESPONSIBILITIES UNDER THE "PARTY WALL ETC. ACT" 1936 WHERE APPLICABLE

AZTECH
ARCHITECTURE LTD

T: 017 807 1465 F: 0208 555 1036
W: www.aztechplans.co.uk
E: mail@aztechplans.co.uk



CLIENT: REHM
SITE:







SCHEME: DOUBLE STOREY EXTENSION TO SIDE
DRAWING NUMBER: AZ-19-16-0003

TO BE READ IN CONJUNCTION WITH: AZ-19-16-8001

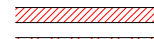
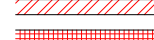
REVISION:

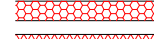
| REFERENCE | BEAM |
|-----------|---|
| F1 | CATNIC C630/100 - 150mm END BEARINGS |
| F2 | CATNIC C630/100 - 150mm END BEARINGS |
| F3 | CATNIC CMSXA - 150mm END BEARINGS OR SIMILAR TO SUIT WALL |
| F4 | CATNIC C630/100 - 150mm END BEARINGS |
| | |
| | |

-  MAINS WIRED FIRE DETECTION AND SIREN POINT - INTERLINKED WITH BATTERY BACKUP
-  FIRE DOOR FDSO RATED WITH INTUMESCENT STRIPS

-  FACING BRICKWORK WITH DETAILING
-  MEDIUM DENSITY BLOCKWORK
-  DENSE CONCRETE BLOCK MINIMUM 1850kg/M²
-  LIGHTWEIGHT BLOCKWORK - CELCON SOLAR OR SIMILAR
-  STANDARD STUD PARTITION
-  STUD PARTITION SUBJECT TO PART E
-  UPGRADED WALL FOR THERMAL RESISTANCE
-  UPGRADED WALL FOR SOUND RESISTANCE

MEANS OF ESCAPE WINDOW TO PROVIDE MINIMUM 0.33M² CLEAR OPENABLE AREA MINIMUM 450MM IN ANY DIRECTION FIRE HINGES TO BE FITTED TO UPVC WINDOWS

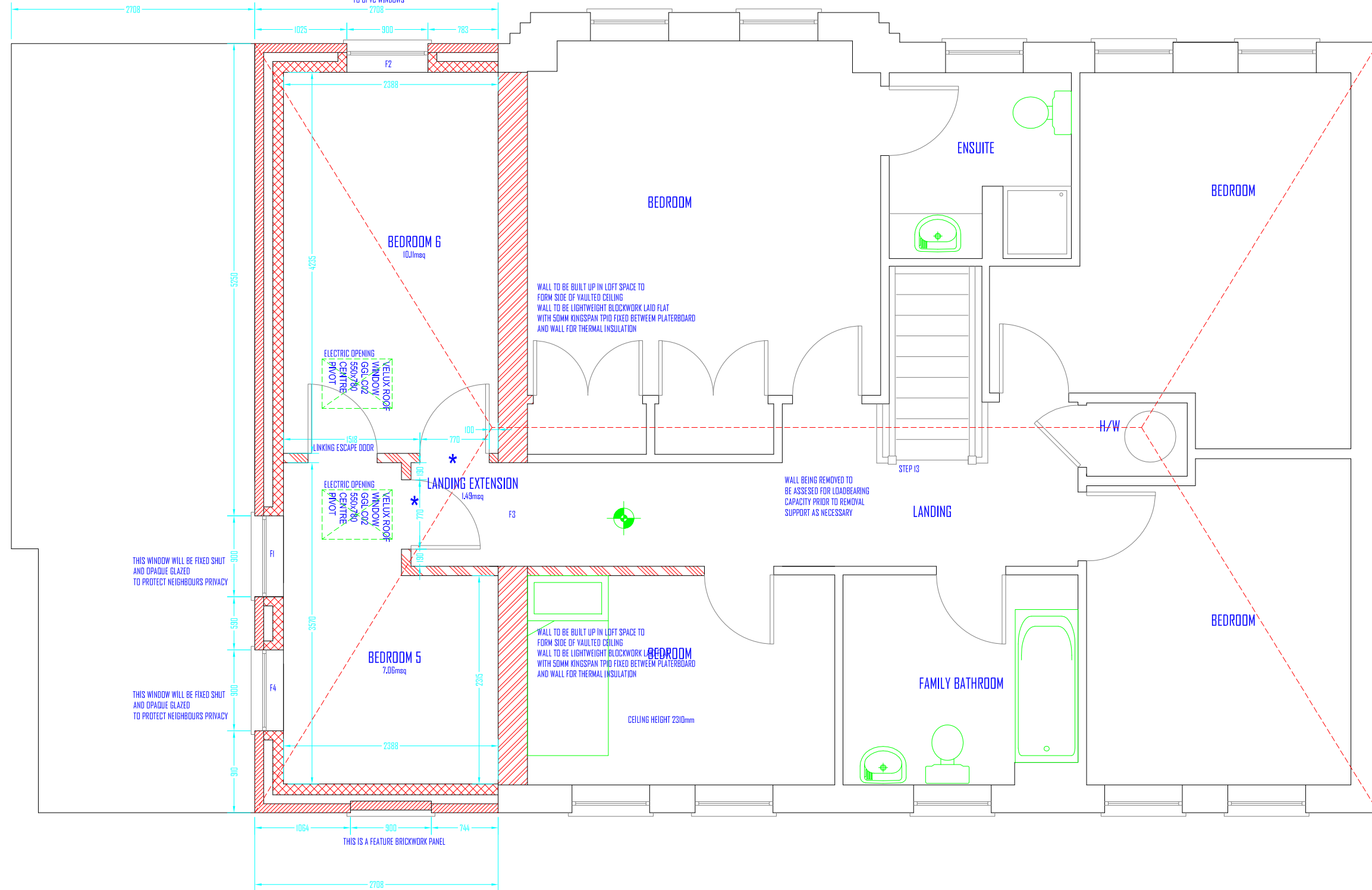

PROPOSED FIRST FLOOR PLAN 1:50 @ A3

COPYRIGHT AZTECH ARCHITECTURE LTD
 RESPONSIBILITY IS NOT ACCEPTED FOR ERRORS MADE BY OTHERS IN SCALING FROM THIS DRAWING
 ALL DIMENSIONS, LEVELS AND ANGLES TO BE CHECKED ON SITE BY CONTRACTOR
 ALL BOUNDARIES ARE ASSUMED AND WE ACCEPT NO LIABILITY FOR BOUNDARY INACCURACY
 YOU ARE REMONDED OF YOUR RESPONSIBILITIES UNDER THE "PARTY WALL ETC. ACT" 1936 WHERE APPLICABLE

AZTECH
 ARCHITECTURE LTD

T: 017 807 4465 T: 0208 555 1036
 W: www.aztechplans.co.uk
 E: mail@aztechplans.co.uk

CLIENT: REHM
 SITE:

SCHEME:
 DOUBLE STOREY EXTENSION TO SIDE

TO BE READ IN CONJUNCTION WITH: AZ-166-8001
 DRAWING NUMBER: AZ-166-0008

REVISION:



PROPOSED FRONT ELEVATION 1:100 @ A3

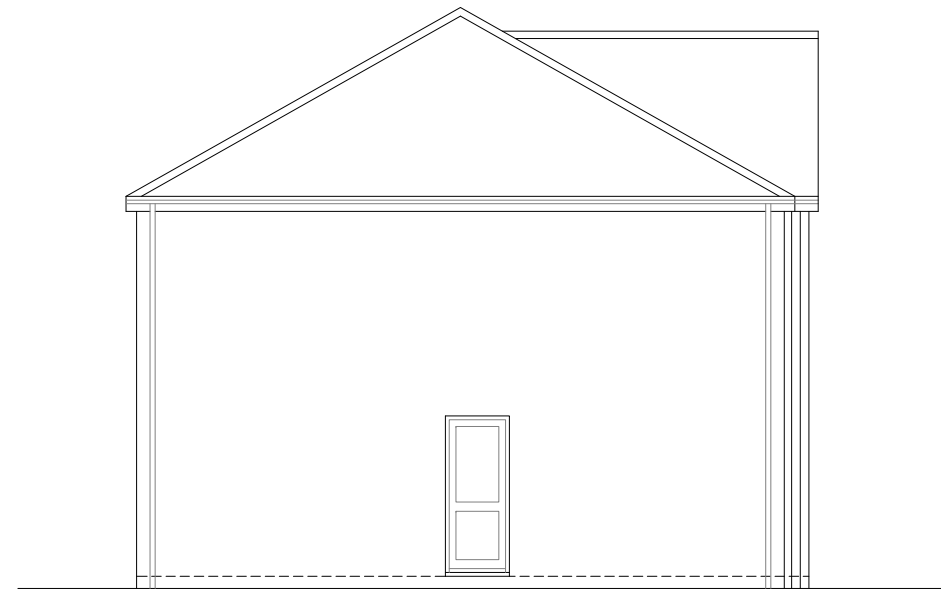

PROPOSED SIDE ELEVATION 1:100 @ A3

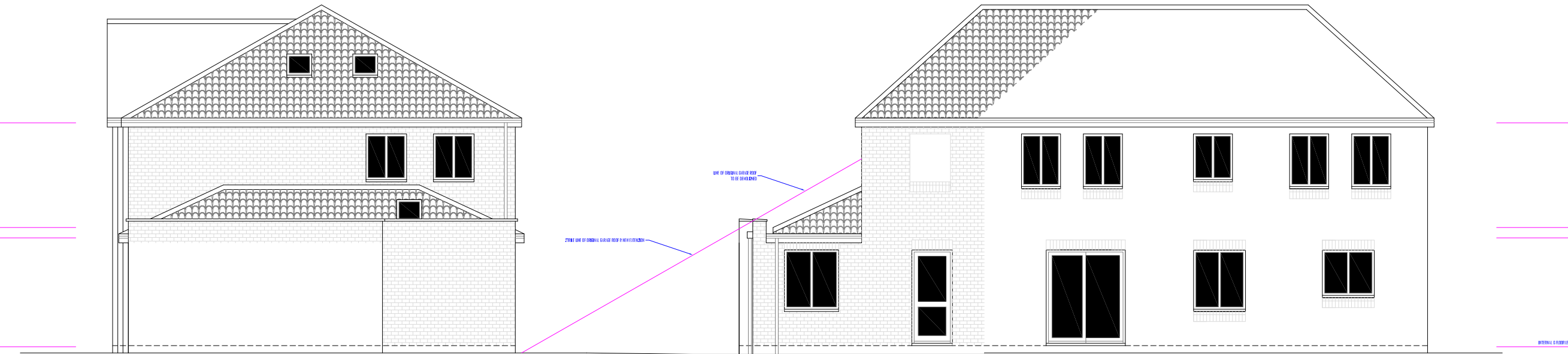

PROPOSED SIDE ELEVATION 1:100 @ A3

PROPOSED REAR ELEVATION 1:100 @ A3

FACING BRICKWORK WITH ASSOCIATED DETAILING TO MATCH EXISTING
 ROOF TILES TO MATCH EXISTING
 WINDOW STYLE AND MATERIALS TO MATCH EXISTING
 SOFFITS AND FASCIAS TO MATCH EXISTING
 RAINWATER GOODS TO MATCH EXISTING

COPYRIGHT AZTECH ARCHITECTURE LTD
 RESPONSIBILITY IS NOT ACCEPTED FOR ERRORS MADE BY OTHERS IN SCALING FROM THIS DRAWING
 ALL DIMENSIONS, LEVELS AND ANGLES TO BE CHECKED ON SITE BY CONTRACTOR
 ALL BOUNDARIES ARE ASSUMED AND WE ACCEPT NO LIABILITY FOR BOUNDARY INACCURACY
 YOU ARE REMINDED OF YOUR RESPONSIBILITIES UNDER THE PARTY WALL ETC. ACT 1986 WHERE APPLICABLE







AZTECH
 ARCHITECTURE LTD

T: 017 807 1465 T: 0208 555 1036
 W: www.aztech.co.uk
 E: mail@aztech.co.uk

CLIENT: REHM
 SITE:

SCHEME:
 DOUBLE / SINGLE STOREY EXTENSION TO SIDE
 TO BE READ IN CONJUNCTION WITH: AZ-646-8001
 DRAWING NUMBER: AZ-646-0006

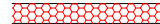
REVISION:

-  FACING BRICKWORK WITH DETAILING
-  MEDIUM DENSITY BLOCKWORK
-  DENSE CONCRETE BLOCK MINIMUM 1850kg/Mcu
-  LIGHTWEIGHT BLOCKWORK - CELCON SOLAR OR SIMILAR
-  STANDARD STUD PARTITION
-  STUD PARTITION SUBJECT TO PART E
-  UPGRADED WALL FOR THERMAL RESISTANCE
-  UPGRADED WALL FOR SOUND RESISTANCE

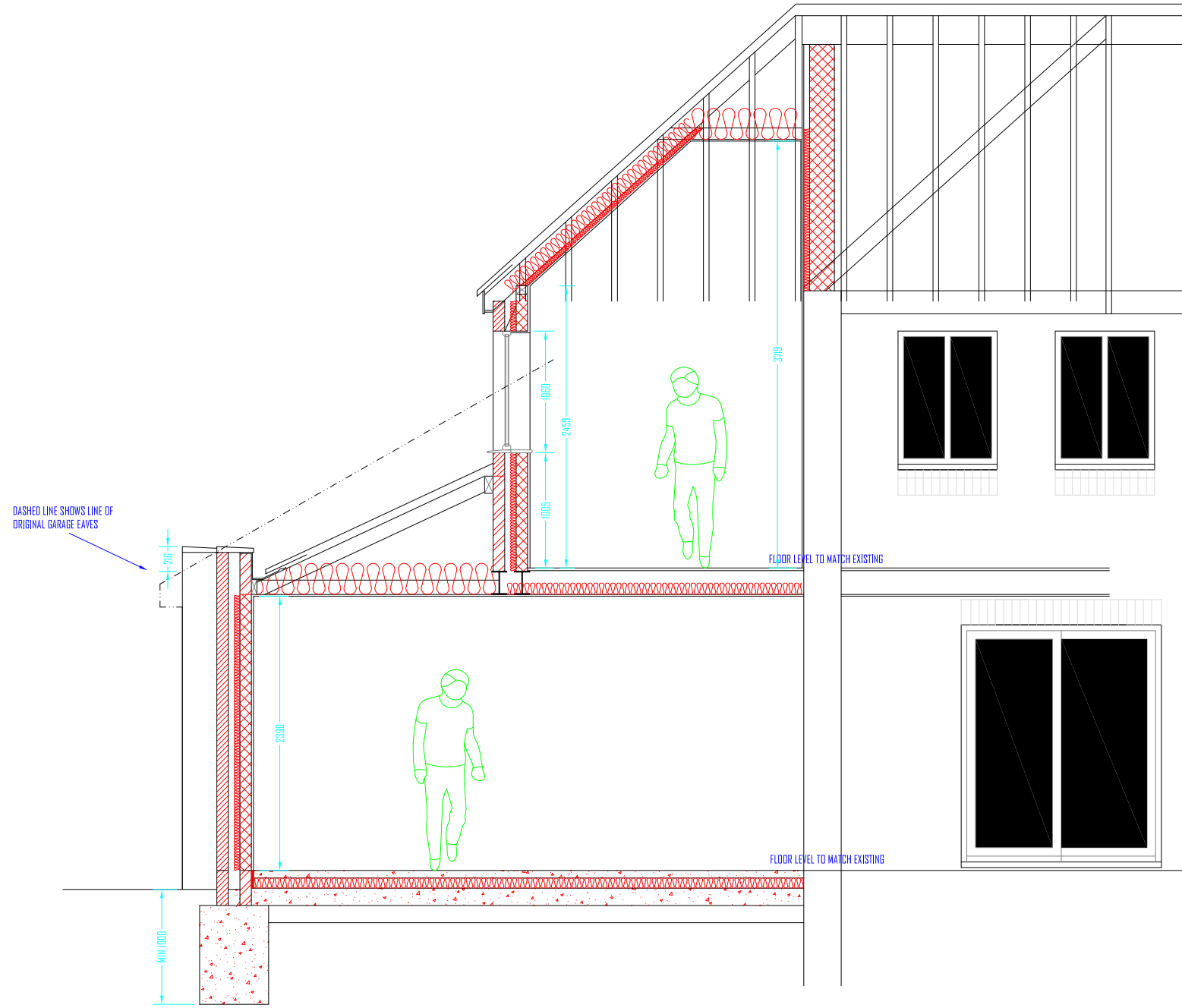

TYPICAL SECTION 1:50 @ A3

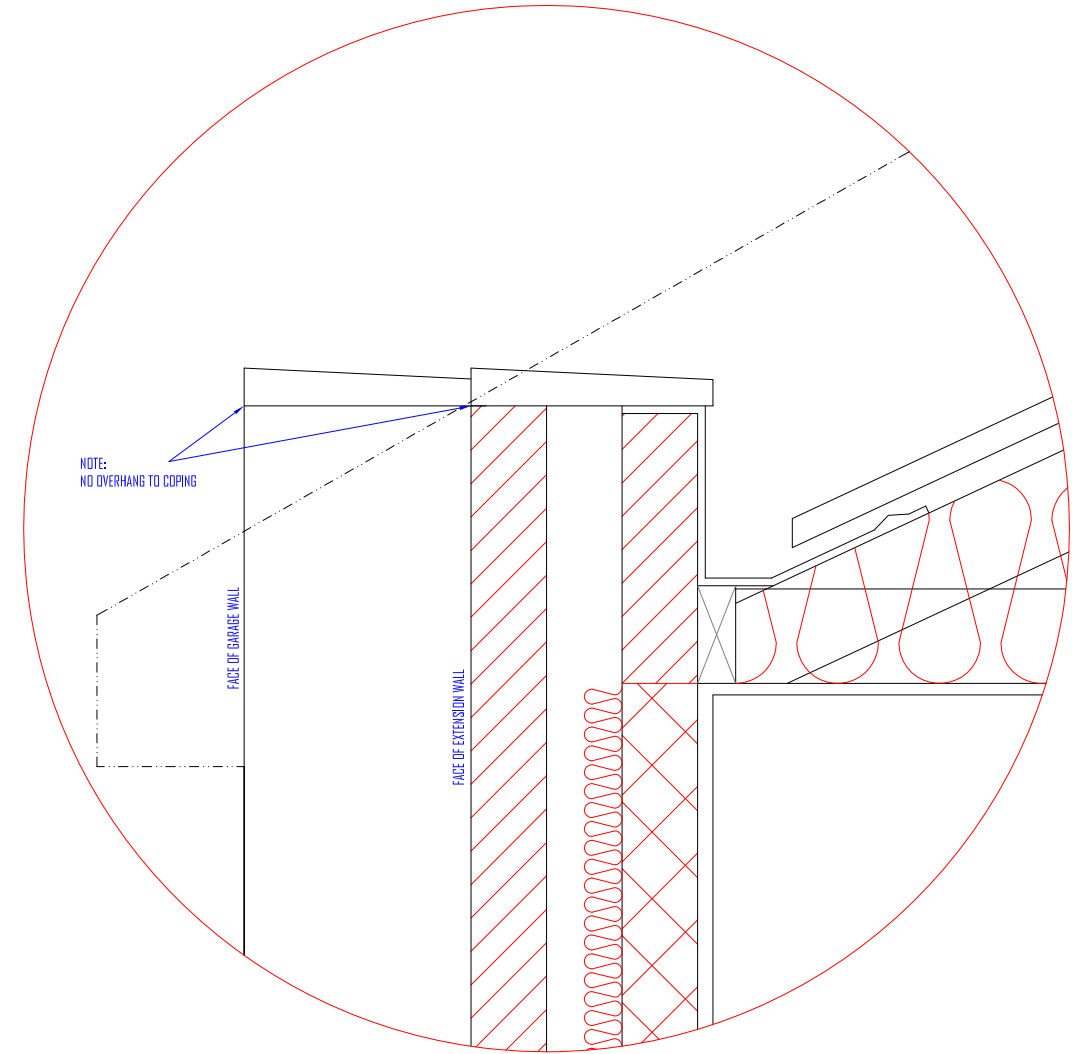

PARAPET DETAIL 1:10 @ A3

COPYRIGHT AZTECH ARCHITECTURE LTD
 RESPONSIBILITY IS NOT ACCEPTED FOR ERRORS MADE BY OTHERS IN SCALING FROM THIS DRAWING
 ALL DIMENSIONS, LEVELS AND ANGLES TO BE CHECKED ON SITE BY CONTRACTOR
 ALL BOUNDARIES ARE ASSUMED AND WE ACCEPT NO LIABILITY FOR BOUNDARY INACCURACY
 YOU ARE REMINDED OF YOUR RESPONSIBILITIES UNDER THE "PARTY WALL ETC. ACT" 1936 WHERE APPLICABLE

AZTECH
 ARCHITECTURE LTD

T: 017 807 4465 F: 0208 555 1036
 W: www.aztech.co.uk
 E: mail@aztech.co.uk

CLIENT: REHM
 SITE:

SCHEME:
 DOUBLE STOREY EXTENSION TO SIDE
 TO BE READ IN CONJUNCTION WITH: AZ-646-800
 DRAWING NUMBER: AZ-646-0008

DATE: 4TH MARCH 2010

REVISION:
C

